



Lodge & Park Guide



SHAWNEE
LODGE & CONFERENCE CENTER

4404B STATE ROUTE 125
WEST PORTSMOUTH, OHIO 45663
T: 740-858-6621 / F: 740-858-4766
www.ShawneeParkLodge.com

explore

Explore the spacious Shawnee Lodge and Conference Center with attractions and amenities such as golfing along the banks of the Ohio River, cool off in the indoor or outdoor pool, boat, fish or explore some of the 65 miles of hiking trails.

Take advantage of the scenic views of the rolling hills from all the cabins and lodge rooms. You will find clean, comfortable, newly renovated rooms and cabins to escape the hustle and bustle of your busy life. Whether you choose to spend your stay relaxing or being adventurous our staff is here to assist.



A scenic view from a wooden gazebo overlooking a lake and forested hills. The gazebo has a shingled roof and a wooden railing. In the background, there is a large body of water (a lake) surrounded by dense green trees and forested hills under a clear blue sky.

*Leave city life behind
and roam the hills, valleys, lakes,
and 63,000-acre Shawnee Forest
at Shawnee Lodge and
Conference Center.*

respice

50 LODGE ROOMS

King Rooms: guestroom with 1 king bed and a private balcony overlooking Shawnee State Forest.

Double Rooms: guestroom with 2 double beds and a private balcony overlooking Shawnee State Forest.

Bunk Rooms: guestroom with 2 double beds, 2 bunk beds and a private balcony overlooking Shawnee State Forest.

Lodge Room Amenities

- » WiFi
- » iron and ironing board
- » LED flat screen TV
- » coffee maker
- » refrigerator
- » hair dryer

25 CABINS

Operational year round

2-Bedroom Family Cabin

One bedroom features a queen bed, the other bedroom features twin bunk beds and a twin/full bunk bed.

Cabin Amenities

- » WiFi
- » heat and air conditioning
- » gas log fireplace
- » iron and ironing board
- » LED flat screen TV in living room and each bedroom
- » fully equipped kitchen
- » charcoal grill
- » fire ring
- » picnic table





*Enjoy the crackling fireplace
in our lower lobby area.
It's the perfect gathering spot.*

meet

Shawnee is ideal for groups of all kinds. Reunions, continuing education and training workshops, board retreats, team-building events, business meetings, association conventions, weddings, and other family celebrations are just some of the groups we host each year. Our professional staff will meticulously attend to every detail of your event, from selecting the perfect layout to creating the unique personal style and theme you envision for all to enjoy. With six meeting and conference rooms, we can very comfortably accommodate up to 250 people. All conference rooms are fully equipped for your meeting needs, including complimentary hi-speed Internet access, and staff to provide audio/visual support. In addition to this conference space, we have lobby areas available for displays, receptions and selected meal functions. All meeting rooms are designated nonsmoking environments. Our Lodge and special amenities, together with our unequalled hospitality, will surely impress you and your attendees, and leave you with a wonderful memory of Shawnee Lodge.





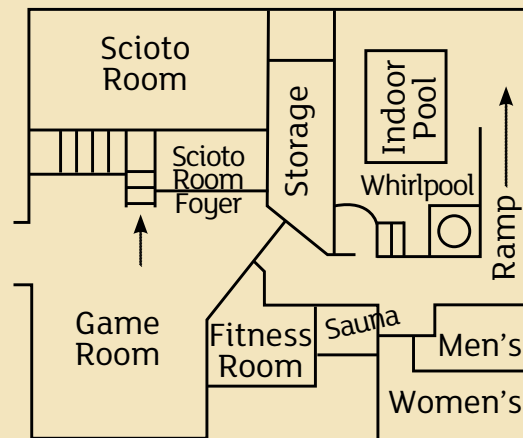

FIRST FLOOR

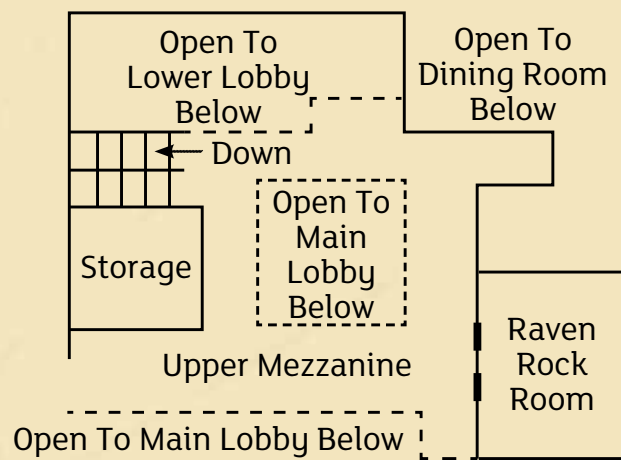
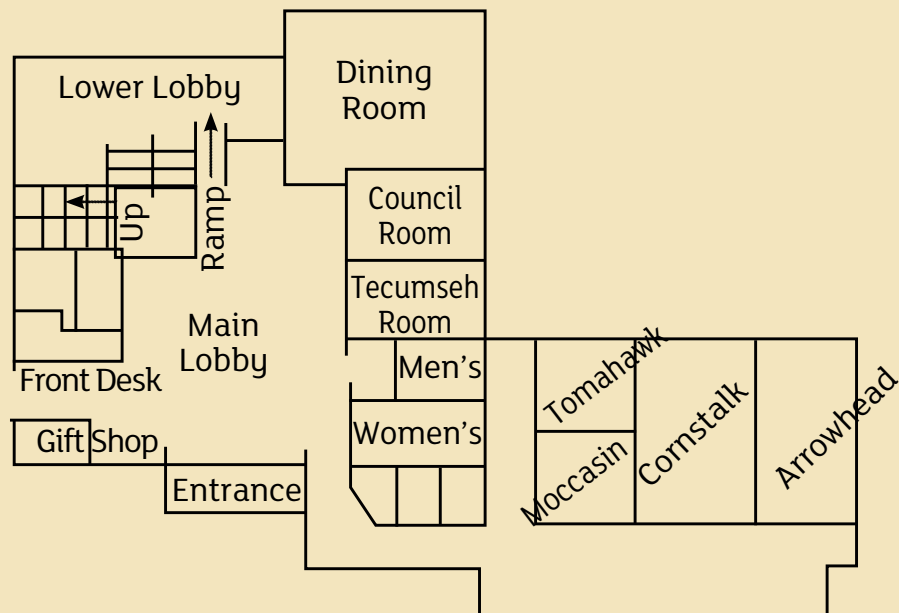

THIRD FLOOR, MEZZANINE LEVEL



play

Lodge Amenities

- » Indoor and outdoor pools
- » Hot tub
- » Tennis courts
- » Shuffleboard
- » Volleyball
- » Basketball
- » Geocaching
- » Game room
- » Fitness Center
- » Playground
- » Family/Children's Programs - seasonal
- » Hiking/Walking/Running/ Biking trails
- » Camping - in designated areas only
- » Beach, Lake, River Fishing
- » Boating and sailing
- » Seasonal nature education programs

Shawnee State Park Lodge Golf Course is a lush course near the banks of the beautiful Ohio River and a short drive from the Lodge.

This beautiful 18-hole championship course is easy to walk and appears tame, but don't be deceived. The par 72 layout sports plenty of water hazards over its 6,407-yard length. This attractive and demanding course was built in 1980 and was designed by Jack Kidwell and Mike Hurdzan.

The course's signature hole, the number 5, overlooks the river valley and has been consistently voted the "most scenic" hole in the tri-state area by several golf publications.

"The natural beauty of the region, coupled with distinct challenges at each hole, makes this course popular with locals and visitors," said Tyson Phillips, resident golf pro.

A fully stocked pro shop and snack bar is open from late February and will remain open every day until early November.







SHAWNEE

LODGE & CONFERENCE CENTER

4404B STATE ROUTE 125
WEST PORTSMOUTH, OHIO 45663
T: 740-858-6621 / F: 740-858-4766
www.ShawneeParkLodge.com

In partnership with Ohio Department of Natural Resources, U.S. Hotel and Resort Management, Inc. will assess a three percent beautification fee on all purchases at the lodge. The monies collected are designated to be used for the continual improvement of the overall lodge and cabin accommodations, and recreation amenities only.